



20
EN 13859-1:2010
EN 13859-2:2010
EN 13984:2013

Notified body no. 1301

A flexible underlayment for discontinuous roofing.
A flexible underlayment for external walls and partitions and flexible sheets for waterproofing.
Plastic and elastomer sheets used as a vapour barrier.
The product consists of a combination of ATI PRO B and ATI PRO A products.
ATI France - 146 Av. du Bicentenaire - 01120 Dagneux - France
DoP no. ATI-PRO COMBI TOITURE-013-0620
available on www.ati-isol.com

ATI PRO A

CHARACTERISTICS	PERFORMANCES	STANDARDS
Reaction to fire	Euroclass F	EN 13984:2013
Watertightness	Watertight at 2 kPa	
Resistance to water vapour	Sd = (87 ± 15) m μ = (1345 ± 220) Zp = (450 ± 76). 10 ⁹ m ² .s.Pa/kg	
Durability: - After ageing - At bases	Past PND *	
Resistance to nail tearing (nail shank)	LD: ≥ 230 N TD: ≥ 226 N	
Tensile properties: - Tensile strength according to longitudinal and transversal direction - Maximal elongation according to longitudinal and transversal direction	LD: ≥ 725 N/50 mm Elong. ≥ 30 % TD: ≥ 660 N/50 mm Elong. ≥ 6 %	
Impact resistance	PND *	
Resistance of the joint	≥ 56 N/50 mm	
* Performance not determined		



* Information on the level of emissions of volatile substances in indoor air, preventing a risk of inhalation toxicity via a class scale from A+ (very low emissions) to C (high emissions)

ATI PRO B

CHARACTERISTICS	PERFORMANCES	STANDARDS
Reaction to fire	Euroclass F	EN 13859-1:2010
Watertightness	Class W1	EN 13859-2:2010
Ownership of water vapour transmission	Sd = (84 ± 11) m	EN 13859-2:2010
Tensile properties: - Tensile strength and maximum elongation	LD: (737 ± 35) N/50 mm Elong. (31 ± 7) % TD: (642 ± 53) N/50 mm Elong. (9 ± 2) %	EN 13859-1:2010 EN 13859-2:2010
Resistance to nail tearing (nail shank)	LD: (256 ± 6) N TD: (265 ± 13) N	
Flexibility at low temperatures	Min. - 40°C	
Artificial ageing due to exposure to UV and heat. Tests after exposure: - Watertightness: - Tensile properties:	Class W1 LD: (619 ± 40) N/50 mm Elong. (23 ± 3) % TD: (569 ± 85) N/50 mm Elong. (11 ± 1) %	

Réf DC0720 - ATI insulation reserves the right, according to the evolution of knowledge and techniques, to modify without notice the composition and conditions of use of its materials. Document and photographs are not contractual. Registered trademarks and patents. SIRET 443 760 691 00041.



ATI[®] COMBI TOITURE MULTI-REFLECTIVE INSULATION with integrated HPV screen INSULATION & AIRTIGHTNESS SYSTEM

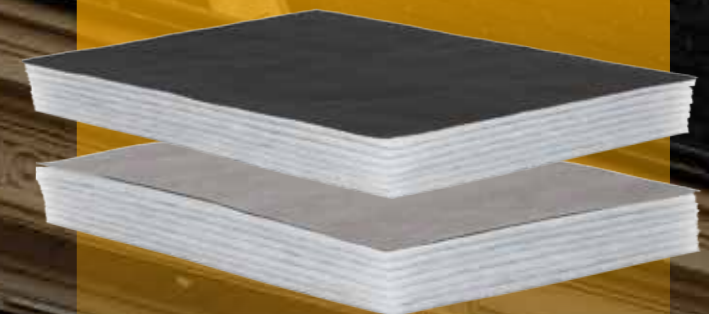

ATI ISOLATION

146, Avenue du Bicentenaire
01120 DAGNEUX - France
Ph : 00 33 (0)4 78 80 51 89
Fax : 00 33 (0) 04 78 80 94 39
info@ati-isol.com - www.ati-isol.com



COMBI TOITURE, the newest addition to the ATI® range

This product is specially suited to the insulation of roofs from the outside. Its thermal performance in excess of **R = 6.46 m² K/W** means that it can provide maximum results with a minimum of thickness.

With its HPV underlayment, **COMBI TOITURE** is airtight and watertight. EN 16012 certified, **COMBI TOITURE** is eligible for support for energy efficiency retrofits.

Insulation works must meet **R** performance criteria and must be carried out by an EGR tradesman to benefit from support, according to legislation in force.



The main forms of support are

- Tax credit for energy transition (CITE)
- Assistance from ANAH
- Energy savings certificate (ESC)
- 0% eco-loan (Eco-PTZ)
- Reduced VAT rate of 5.5%



Crédit d'Impôt Transition Énergétique (CITE). Voir les textes en vigueur.

CERTIFIED THERMAL PERFORMANCES

- High-performance insulation
- Total air- and watertightness
- Comfortable both in summer and winter
- Simple, easy, and quick to install
- Healthy and durable insulation



Combi Toiture	Thermal resistance R (m²K/W)	Reference standards	Test reports
Roof with a slope of 10°	6,46	NF EN 16012 EN ISO 6946 : 2019	KTU no. 081 SF/19
Roof with a slope of 30°	6,54		
Roof with a slope of 45°	6,60		

Multi-reflective insulation with HPV* screens	Intrinsic thermal resistance R (m² K/W)	Reference standards	Test reports
PRO A Grey screen	2,90	NF EN 16012 : 2012+A1 : 2015	KTU no. 065-2 SF/19 U
PRO B Black screen	2,64		KTU no. 031-1 SF/19 U

* HPV : Hautelement Perméable à la Vapeur d'eau

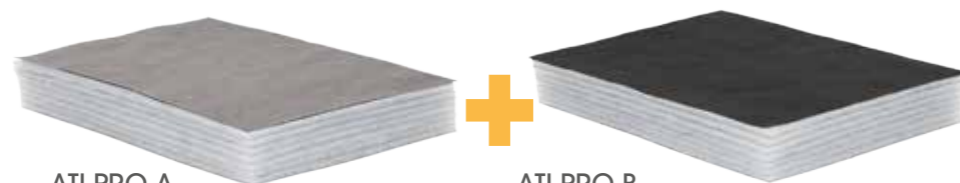

ATI PRO A
Interior, hot side

ATI PRO B
Exterior, cold side

Nominal thickness	65 mm*	65 mm*
Area density	850g/m²	765g/m²
Packaging	Roll	Roll
Individual	1,50 m x 11,50 m = 17,25 m² ± 3 %	1,50 m x 10 m = 15 m² ± 3 %
Pallet of 12 packs of 2 rolls Combi Toiture 24 rolls on the same pallet Pallet of 1.1m x 1.5m x 1.6m high	12 rolls of PRO A = 207 m² ± 3 %	12 rolls of PRO B = 180 m² ± 3 %

* Thickness can vary according to the compressions on the roll.

INSULATION & AIRTIGHTNESS SYSTEM

ATI® COMBI TOITURE IS A SYSTEM THAT COMBINES 2 DIFFERENT PRODUCTS: ATI PRO A AND ATI PRO B

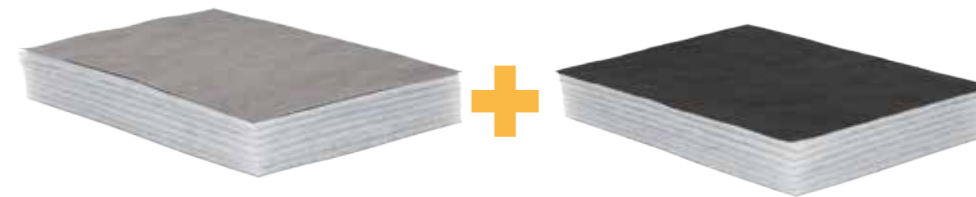

ATI PRO A
HOT SIDE

- Nominal thickness: 65 mm
- Dimensions l x L : 1,50 m x 11,50 m
- Roll of 17,25 m²

ATI PRO B
COLD SIDE (BLACK mate face on exterior)

- Nominal thickness: 65 mm
- Dimensions l x L : 1,50 m x 10 m
- Roll of 15 m²



DOUBLE INSTALLATION

AN EFFECTIVE AND THE MOST RAPID SOLUTION.

The double counter-battens guarantee a regular air gap between the two insulation products.

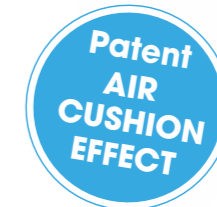
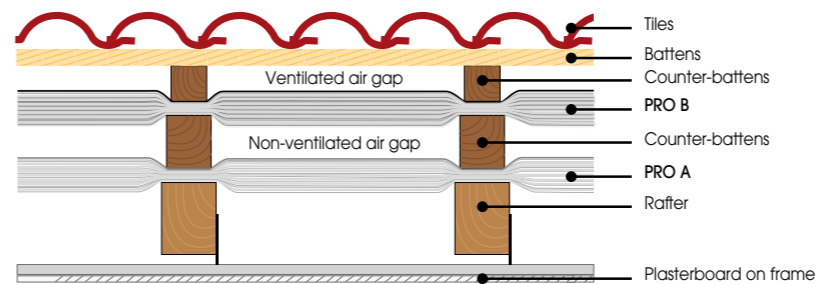

INSTALLATION ON A RACK

REDUCES EXCESS HEAT IN THE ROOF.

Installation suited for renovation while at the same time preserving the general aesthetic of the roof.

It requires the adaptation of an air gap of 20 to 30 mm between the 2 insulation products, with the PRO A insulation clipped onto the set of rafters for installation on a rack.

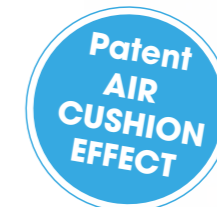
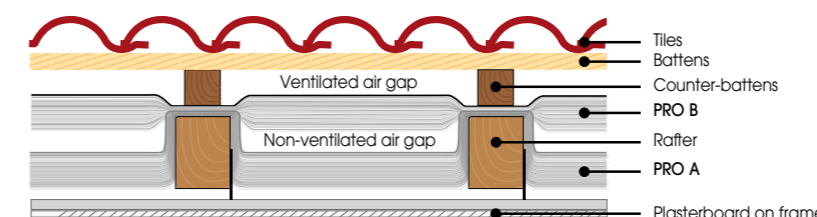

Refer to the technical dossier for installation details. Available on request or on www.ati-isol.com